

Before you begin

This product has been packaged to ensure it arrives in the best possible condition. Please be careful when unpacking. This kit contains parts that can be damaged if incorrectly assembled. Please follow instructions.



Hoselink's Heavy-Duty Hose Reel Cart has been designed and manufactured using the highest quality materials to take all the work out of watering, gardening and cleaning.

Product Features:

- Cam-lever braking helps with the drag of the hose when in use. When pulling the hose out ensure the brake is in the ON position then flip the lever to the OFF position to release the brake for a drag-free rewind.
- Powder coat finish in our popular taupe colour that will look great in any garden!
- Aluminum-alloy and stainless steel construction throughout provides a rustproof, long-lasting watering solution.
- Heavy-duty rubber tyres provide easy movement on any terrain
- Impact resistant crank handle spins freely ensuring a hassle-free rewind action
- Push/Pull handles have been positioned at 915mm using rubber sleeves for an easy-grip solution.
- Smartly engineered to suit both left and right handed people, simply decide which direction your reel will function when fitting your garden hose.

Important!

Before installation, please make sure you have all the parts as shown on the 'Box Contents' section, then you may start installation from step 1.

Please note: partial assembly has been completed during manufacturing for packing purposes.

Box Contents

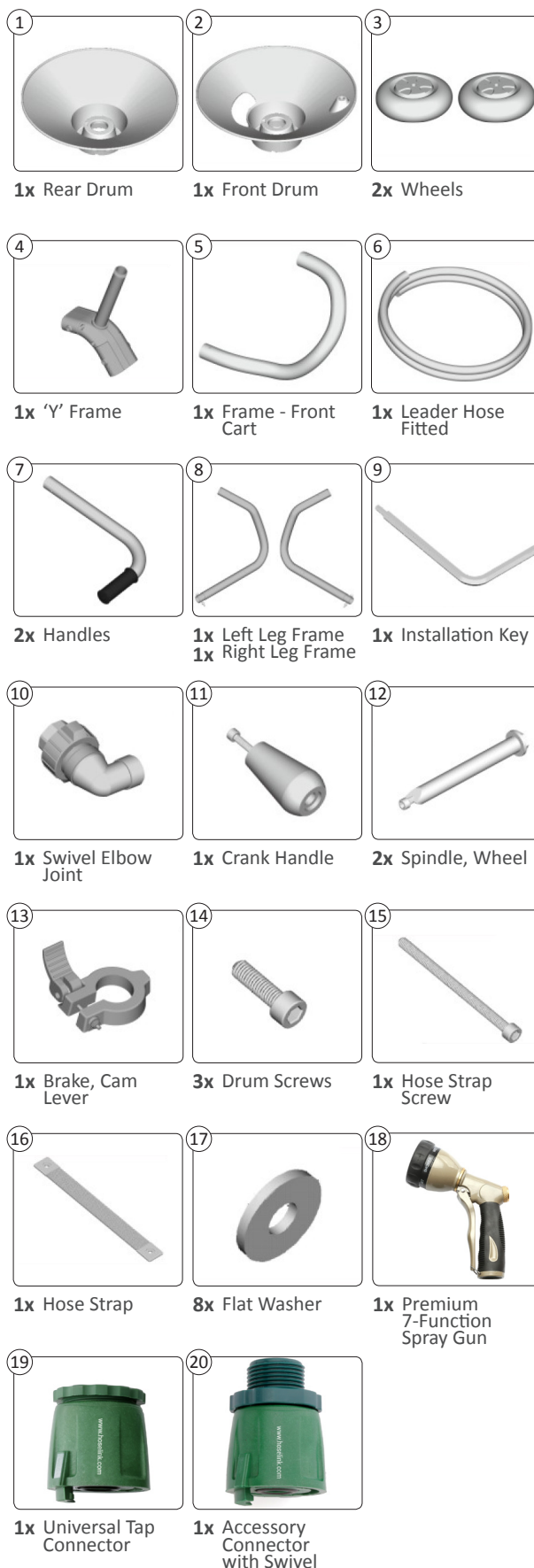

User Manual

Heavy-Duty Hose Reel Cart | Models: 3580 / 3581

Cart Assembly

Step 1

Place the Front Drum (2) on top of the Back Drum (1). The correct alignment can be achieved once the pins and sockets are secured in place.

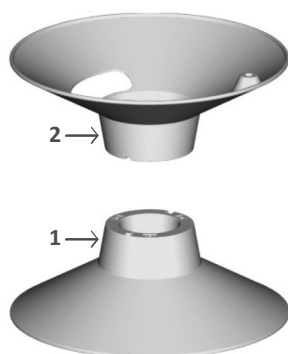

Step 2

Fasten drums together using the three Drum Screws (14) and put 3pcs washer (17) and the small hex end of the installation key (9).

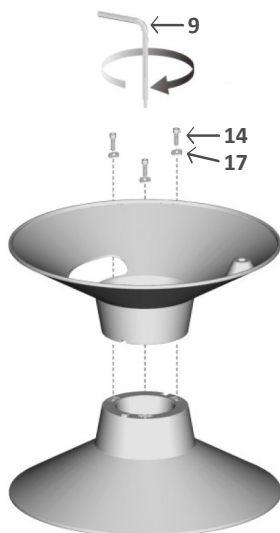

Step 3

Remove the screw from the Handle.

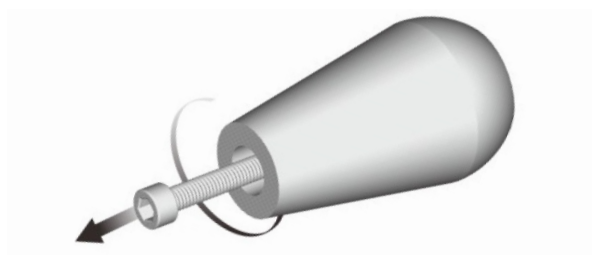

Step 4

Place crank handle into correct position, secure included screw in place using the Installation key (9)

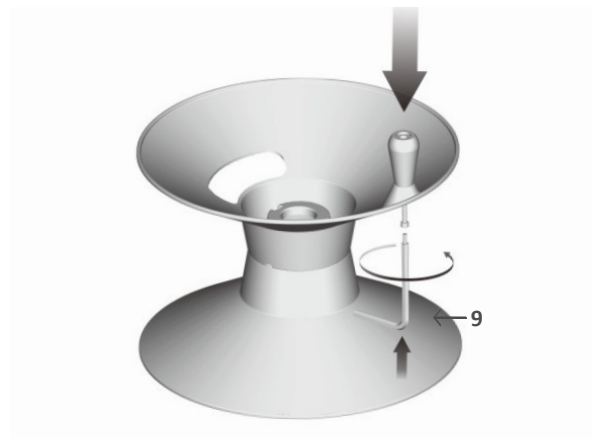

Step 5

Remove the Screws from the Wheel Spindle (12)

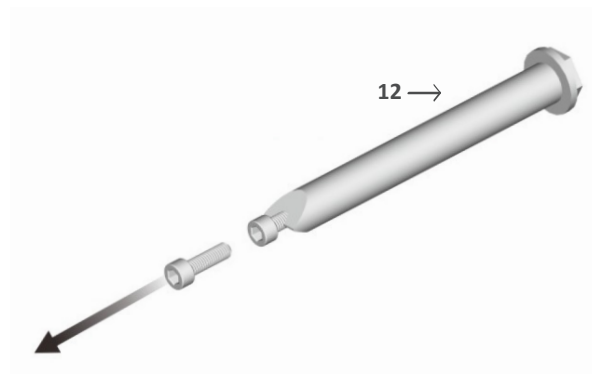

Step 6

Install the Wheels (3) to the Left and Right Cart Legs (8). Be sure the raised section of the wheel is against the cart leg.

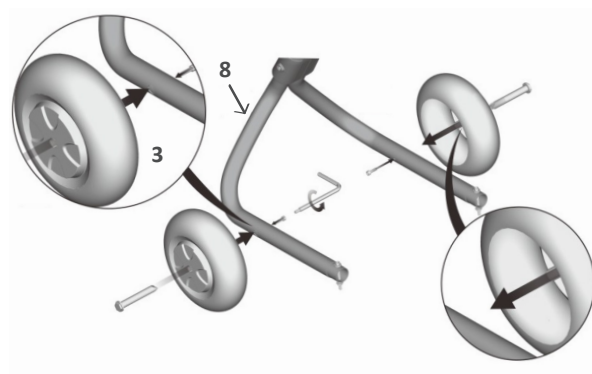

Step 7

Remove the Screws, Flat Washer and Lock Nuts from each of the Cart Legs (8).

Insert the Front Cart Frame (5) into each of the Left and Right Cart Legs (8). Insert the Screws and Flat Washers (17).

Note: Do not install the nuts at this time.

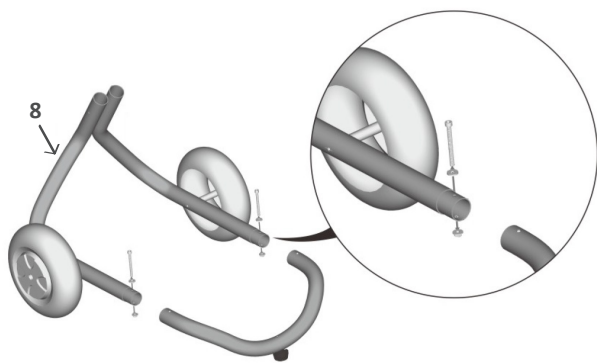

Step 8

Remove the set of Screws, Flat Washers, Cart Leg Clamps and Lock Nuts from the Cart 'Y' Frame Assembly (4).

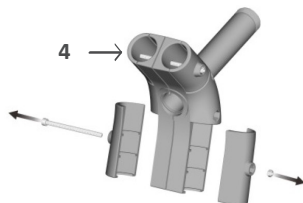

Step 9

Slide the Cart 'Y' Frame Assembly (4) onto the Cart Legs (8). Install the Screws, Flat Washers, Cart Leg Clamps and Lock Nuts, tighten with the installation key (9).

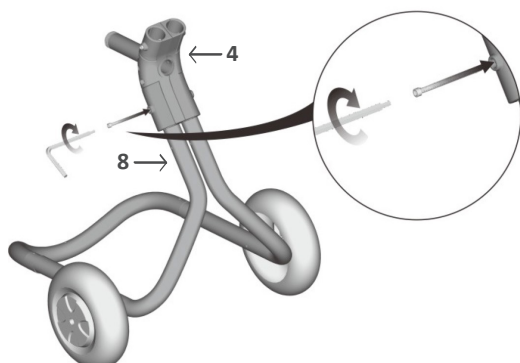

Step 10

Install the Serrated Lock Nuts onto the Screws. Tighten with the installation key (9).

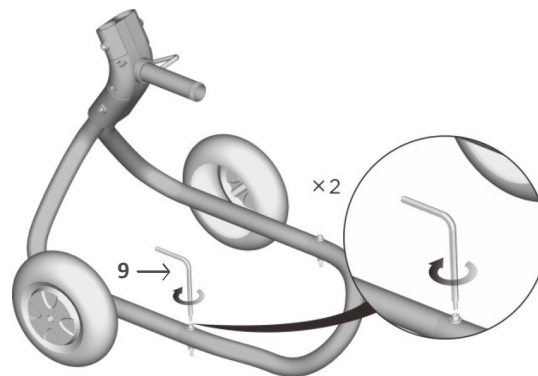

Step 11

Install the Serrated Lock Nuts onto the Screws. Tighten with the installation key (9).

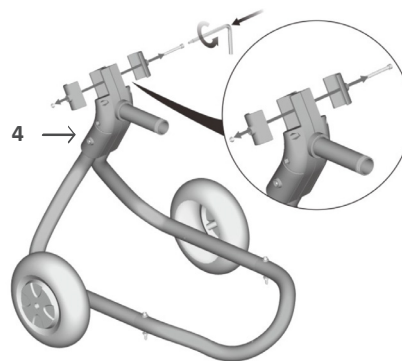

Step 12

Install the Cart Handles (7), with the hardware just removed, tighten with the installation key (9).

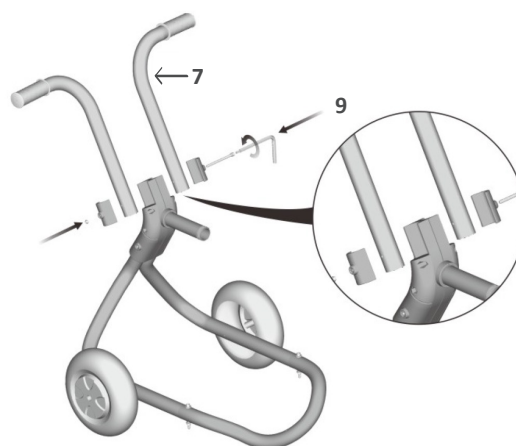

User Manual

Heavy-Duty Hose Reel Cart | Models: 3580 / 3581

Step 13

Install the Flange Assembly onto the axle ensuring the crank handle is on the outside.



Step 14

Install the Cam-lever Brake (13) onto the axle.

Note: Align the tab on the brake with the notch in the flange.

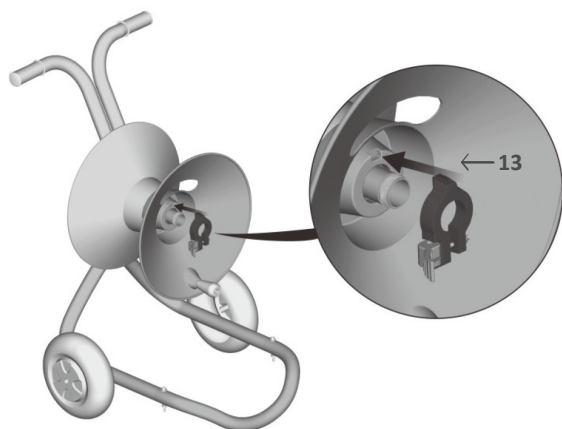

Step 15

Thread the leader hose (6) through the axle until it is accessible from the other side.

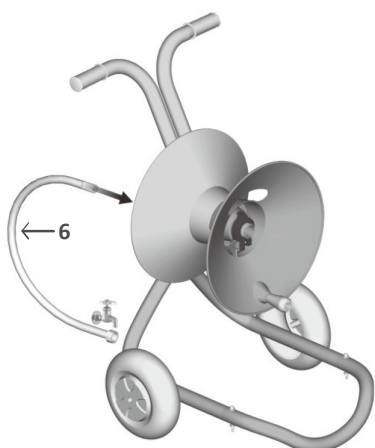

Step 16

Attach the Swivel (10) to the leader hose.

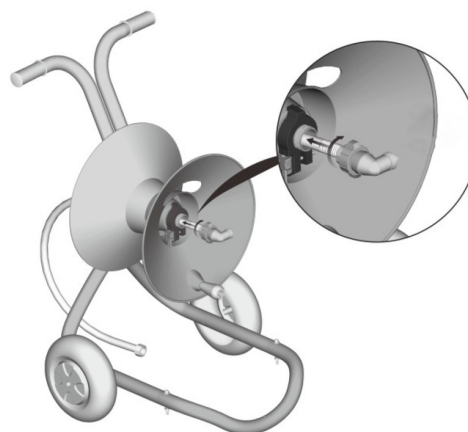

Step 17

Screw the swivel firmly onto the axle. Ensure to hand tighten only.

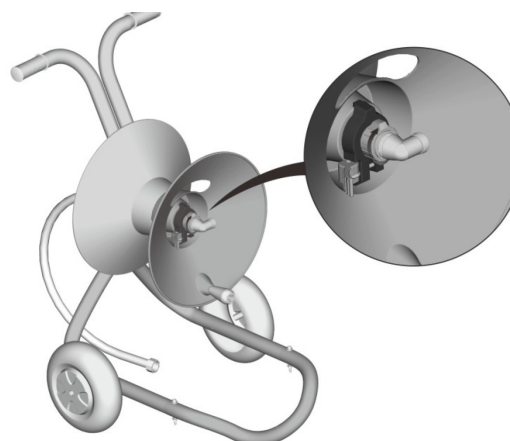

Hose Installation

Step 1

If you are right handed: Install the hose as per images.

If you are left handed: Install the hose in the opposite direction. The hose will then wind up from the right hand side.

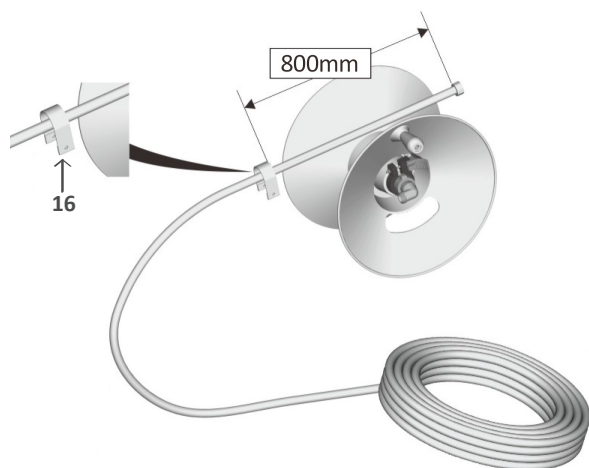

Step 2

Position the Hose strap (16) so the grommets pass through the small slot in the flange.

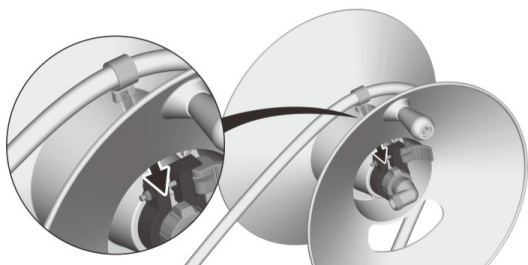

Step 3

Tighten the hose strap. The Hose Strap Screw (15) will pass through the 1/4 inch Flat Washer (17) and the two brass grommets on the hose strap and then thread into the nut on the reel flange assembly.

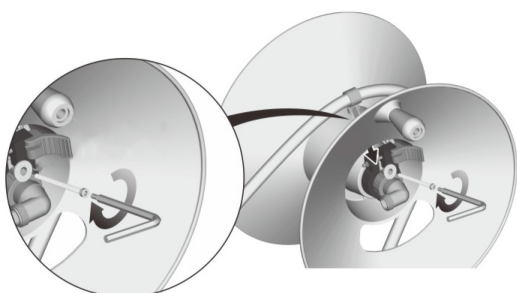

Step 4

Hand tighten your garden hose to the brass swivel.

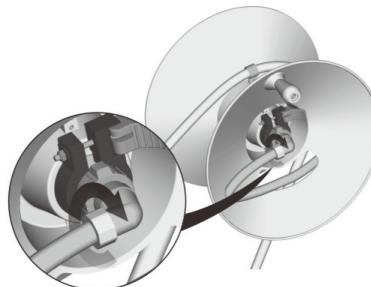

How to use the Cam-Lever Brake

As you pull the hose from the reel, our innovative cam-lever brake will prevent the reel from “free-spinning”, unrolling more hose than you want. The brake can be turned ON and OFF using the lever.

Brake on: Pulling the Hose out.

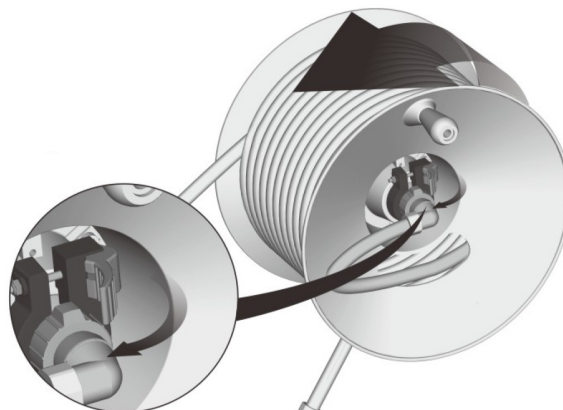

Brake off: Reeling the hose in.

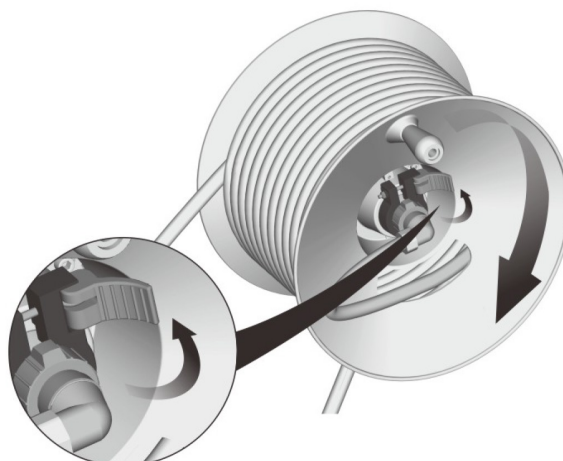

User Manual

Heavy-Duty Hose Reel Cart | Models: 3580 / 3581

How to adjust the Cam-Lever Brake

Step 1

Place the Cam-Lever in the 'ON' position.

Step 2

Pull enough hose off the reel to test the amount of drag created by the Cam-Lever break.

Too little drag: The reel will continue to unspool hose after you've stop pulling.

- Tighten the nut on the Cam-Lever Brake using a 3/8" wrench.
- Adjust 1/4 turn of the wrench.
- Test again.

Too much drag: It will be difficult to pull hose off the reel.

- Loosen the nut on the Cam-Lever Brake using a 3/8" wrench.
- Adjust 1/4 turn of the wrench.
- Test again.

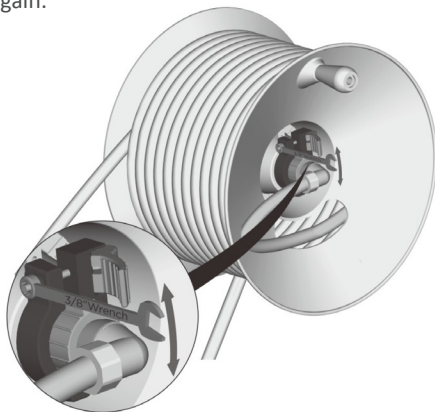

Warranty

Hoselink's mission is to offer excellent products and exceptional after sales support. Your hose reel carries a 3 years warranty from the date of purchase. Should you require trouble-shooting advice or after sales care, please contact us via telephone or email and our Customer Care team will assist you.

Our goods come with guarantees that cannot be excluded under the Australian Consumer Law. You are entitled to a replacement or refund for a major failure and for compensation for any other reasonably foreseeable loss or damage. You are also entitled to have the goods repaired or replaced if the goods fail to be of acceptable quality and the failure does not amount to a major failure.

If a Product has a minor defect, we will provide a repair or offer you a replacement or a refund. If you think that a Product is defective you should contact our Customer Care team within 14 days and a Customer Care representative will assist you. A photo may be requested to assist with the assessment of your claim.

Where a Product is defective and needs to be replaced or repaired, return shipping will be arranged at the expense of Hoselink. This must be arranged with Customer Care prior to the item being returned. If a Product is replaced, your replacement Product becomes your property and the returned Product becomes our property. When a refund is given, the returned Product becomes our property.

Should you ever require any assistance with your Hoselink product, please do not hesitate to contact us for a speedy resolution.

FOR ALL WARRANTY CLAIMS, PLEASE CONTACT CUSTOMER CARE:

Tel: 1300 900 617

Email: hello@hoselink.com.au



Website

www.hoselink.com.au

Email

hello@hoselink.com.au

Telephone

1300 900 617

Office address

1/108 Old Pittwater Rd, Brookvale NSW 2100, Australia

Mailing Address

PO Box 6671, Frenchs Forest NSW 2086