

## Before you begin

This product has been packaged to ensure it arrives in the best possible condition. Please be careful when unpacking. This kit contains parts that can be damaged if incorrectly assembled. Please follow instructions.



### Box contents



1x Cart Assembly



2x Wheel



1x Crank Handle



1x Water System Inlet

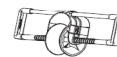

1x Hose Guide Assembly



1x Basket



1x Grab Handle



4x A Self-tapping screw  
(For hose guide)



2x B Threaded screw  
(For drum frame)



1x Hose Clamp  
(To attach the hose)



1x Peg  
(To hold cart in place  
when in use)



**Tools Required:**  
Phillips Head Screwdriver

Carefully remove all the packaging and parts from the box.

## Step 1: Assemble the Cart

- Lift the hose storage drum until the plate matches the plate on the frame, ensuring the holes are aligned.
- Secure the hose storage drum in place with the “B” - Threaded screw provided.

**CAUTION:** Please do not tighten these two screws until step 3.

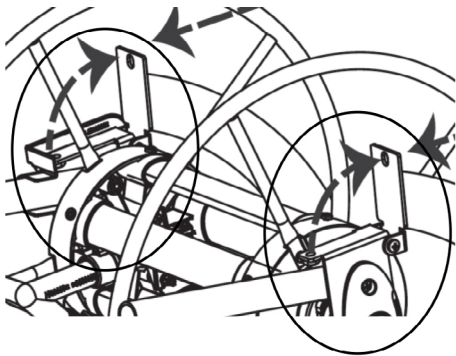
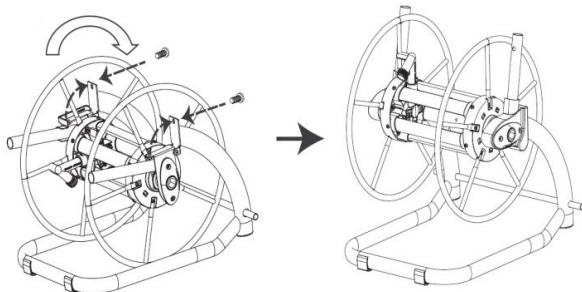

## Step 2: Assemble Hose Guide System

- Place the hose guide system into the opening of the handle, and snap in place making sure the black worm drive is on the bottom.
- Secure in place using the “A” self-tapping screws provided.

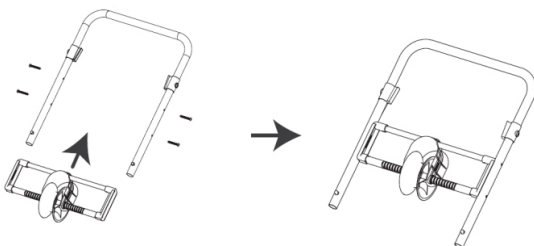

## Step 3: Assemble Handle and Top Tray

Insert the handle into the frame tubes, until the snap button pops up.

- Slide the top tray into the plastic supports on the handle, as shown in the picture.
- Tighten the storage drum screws from step 1.

**CAUTION:** Be careful of pinch points when pressing the button into the holes.

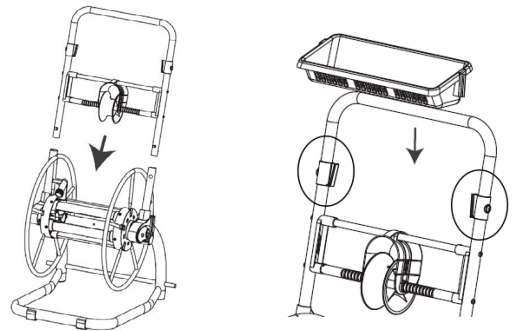

## Step 4: Install Wheels

- Insert wheel (Reference 1) onto the cart axle (Reference 5) and push the wheel axle (Reference 2) into cart axle.
- Put the cover (Reference 3) on the axle and insert the R pin (Reference 4) into the cover.
- Note that the U-pin needs to be inserted into the socket on the cover.
- Repeat the process with the second wheel.

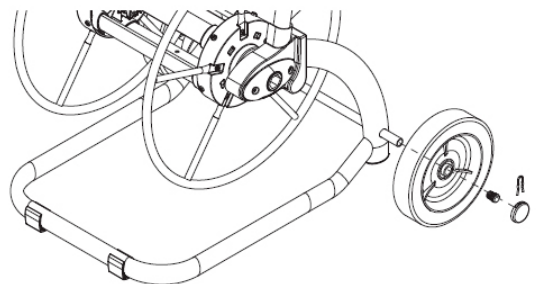
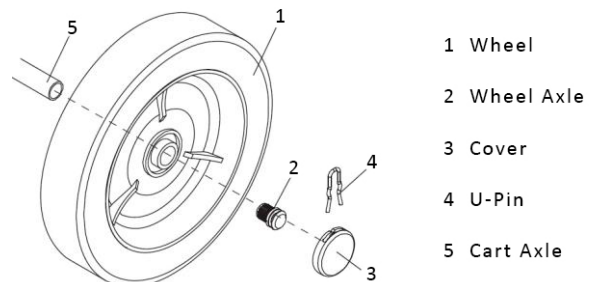

# User Manual

Metal Hose Reel Cart | Models: 3357 / 3358

## Step 5: Install Crank and Water Inlet

- Push the crank handle into the slot on the right hand side of the cart.
- Secure in place using the screw provided.
- Install water inlet by pulling the locking lever down and inserting the water inlet in the desired orientation.
- Make sure the inlet tube is pushed all the way in before closing the locking lever.

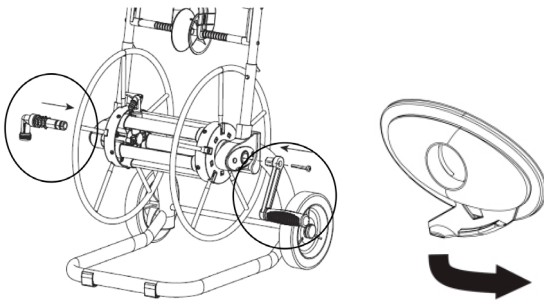

## Step 6: Installing the Hose to the Hose Cart

- Thread hose through the feeder.
- Slide hose clamp over the end of the hose
- Submerge end of hose into boiling water to soften then push hose onto stem.
- Tighten hose clamp with Phillips head

**NOTE:** Hose guide can easily be aligned by rolling the feeder wheel into the correct position which is on the far left hand side.

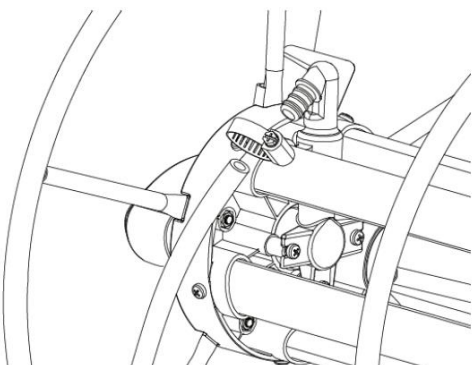

## Operation

**Step 1:** Connect the leader hose to the tap and then connect onto the hose cart using the twist and lock action for the Hoselink fittings.

**Step 2:** Remove length of hose needed from drum.

**Step 3:** Turn water on at tap.

**Step 4:** Use hose for watering.

**Step 5:** Before rewinding hose, bring the nozzle back to cart, turn water off and squeeze nozzle for a few seconds to release pressure in the hose.

**Step 6:** Rewind hose. It is helpful to hold cart in place with one foot while cranking.

## Maintenance

### Annual Seal Lubrication

To prevent leaks and to lengthen seal life, the water inlet seals should be lubricated annually. Reference Figure 1.

- Stop the flow of water to the unit by turning off the tap.
- Release locking lever. Reference Figure 2.
- Pull the inlet tube from the axle.
- Lubricate the seals as indicated. Silicone based lubricant is recommended.
- Replace the inlet tube making sure it is pushed all the way in before closing the locking lever.

## Storage

- Turn water off when not in use.
- Store the item indoors when you don't intend to use it for extended periods.
- To prevent damage from expanding ice, always disconnect and drain all hoses prior to frost and freezing conditions.
- Clean the hose using only mild soap and water.



Website

[www.hoselink.com.au](http://www.hoselink.com.au)

Email

[hello@hoselink.com.au](mailto:hello@hoselink.com.au)

Telephone

**1300 900 617**

Office address

**1/108 Old Pittwater Rd, Brookvale NSW 2100, Australia**

Mailing Address

**PO Box 6671, Frenchs Forest NSW 2086**